

PART NO. SW539

TOLERANCES UNLESS SPECIFIED	
TWO PLACE DECIMALS +/- .015	THREE PLACE DECIMALS +/- .005
ANGLES +/- 1°	

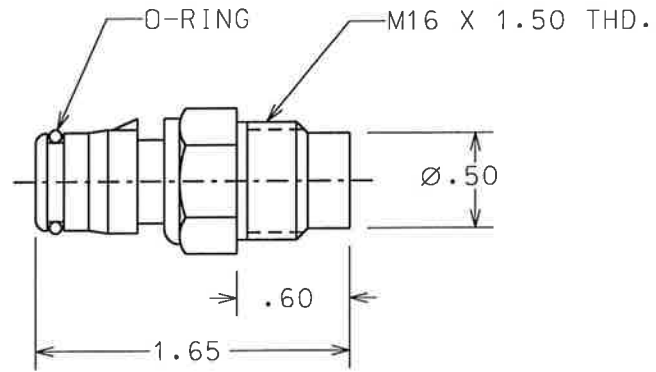

- (A) NOTES:  
 1. REFERENCE "ANSI Y14.5M-1982"  
 2. NO LABELS ARE PERMITTED ON OR BELOW THE THREADS OF THE HOUSING.  
 (B) 3. SWITCH NORMALLY CLOSED, OPENS AT 206°F ±8°F.

REPLACES O.E. TOYOTA #89428-20060

				MATERIAL	SCALE NTS	<b>WELLS</b> MANUFACTURING CORP. FOND DU LAC, WISCONSIN
					DATE 5-18-94 BY DWN. CWS	
B	ADDED NOTE	22098	1-13-99	DPH	ENGINEER 5-18-94 DAL	TITLE COOLING FAN SWITCH
A	ADDED NOTES.	19235	6-30-95	MCS	APPROVED 5-18-94 JSK	
	RELEASED	18448A	5-18-94	CWS	PURCH. <input type="checkbox"/> PROD. <input type="checkbox"/>	PART NO. SW539
L	REVISION	CN	DATE	BY	CAD REF. SW539	MODEL